







# MISSAUKEE COUNTY ROAD COMMISSION LAKE CITY, MICHIGAN

## LEGEND

- STATE TRUNKLINE 
- COUNTY PRIMARY 
- COUNTY LOCAL 
- CITY OR VILLAGE STREET 
- RAILROAD 
- INCORPORATED AREA 

PRIMARY ROAD SYSTEM IS 9.86 MILES  
LOCAL ROAD SYSTEM IS 33.16 MILES

13	14	15	16
9	10	11	12
5	6	7	8
1	2	3	4

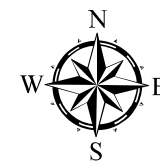

0 0.25 0.5 1  
 Miles

1 inch equals 3,500 feet

Missaukee Co - 57

T. 23N, R. 07W

**FOREST TWP - 10**

Prepared by  
MISSAUKEE COUNTY ROAD COMMISSION

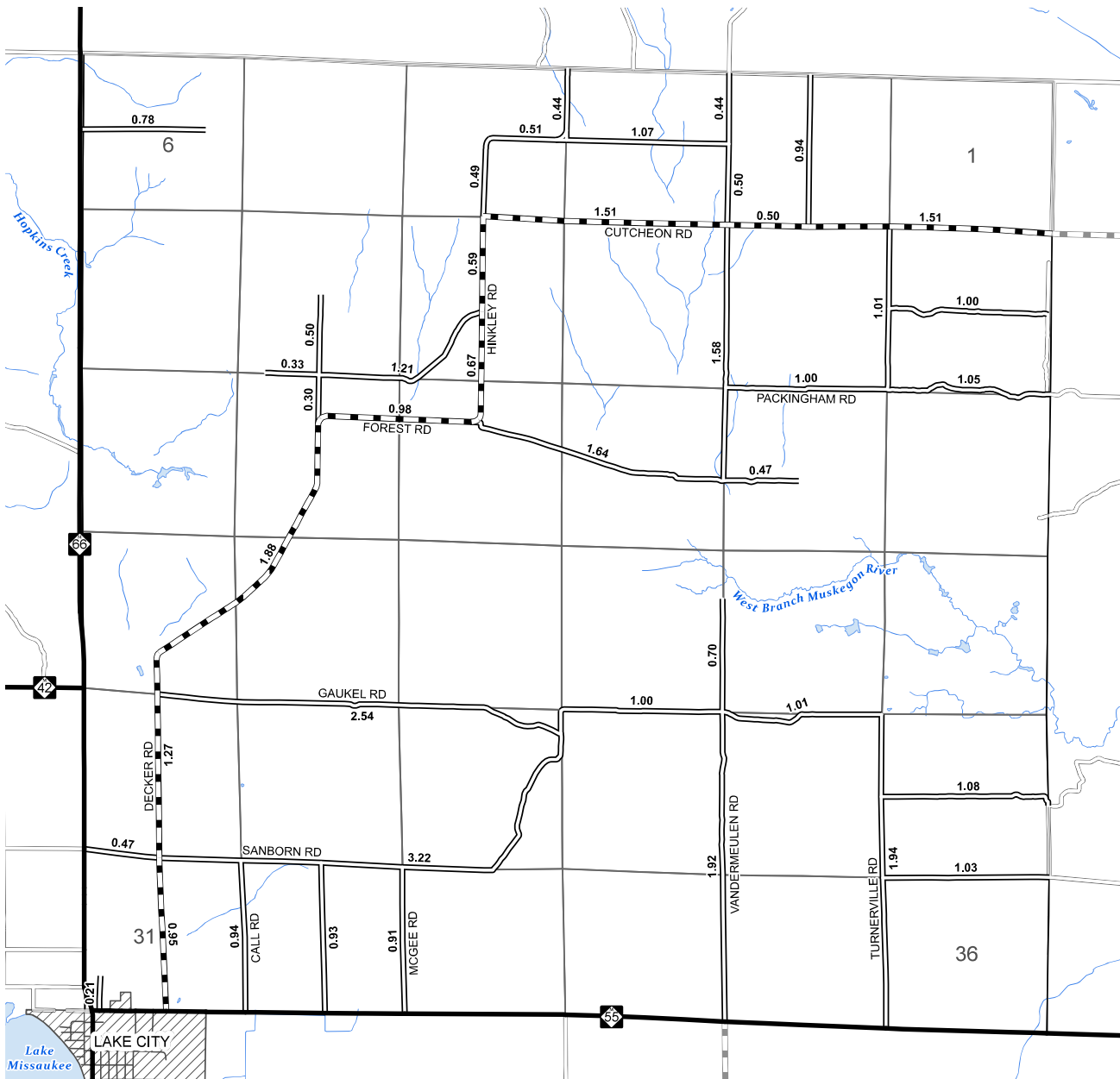

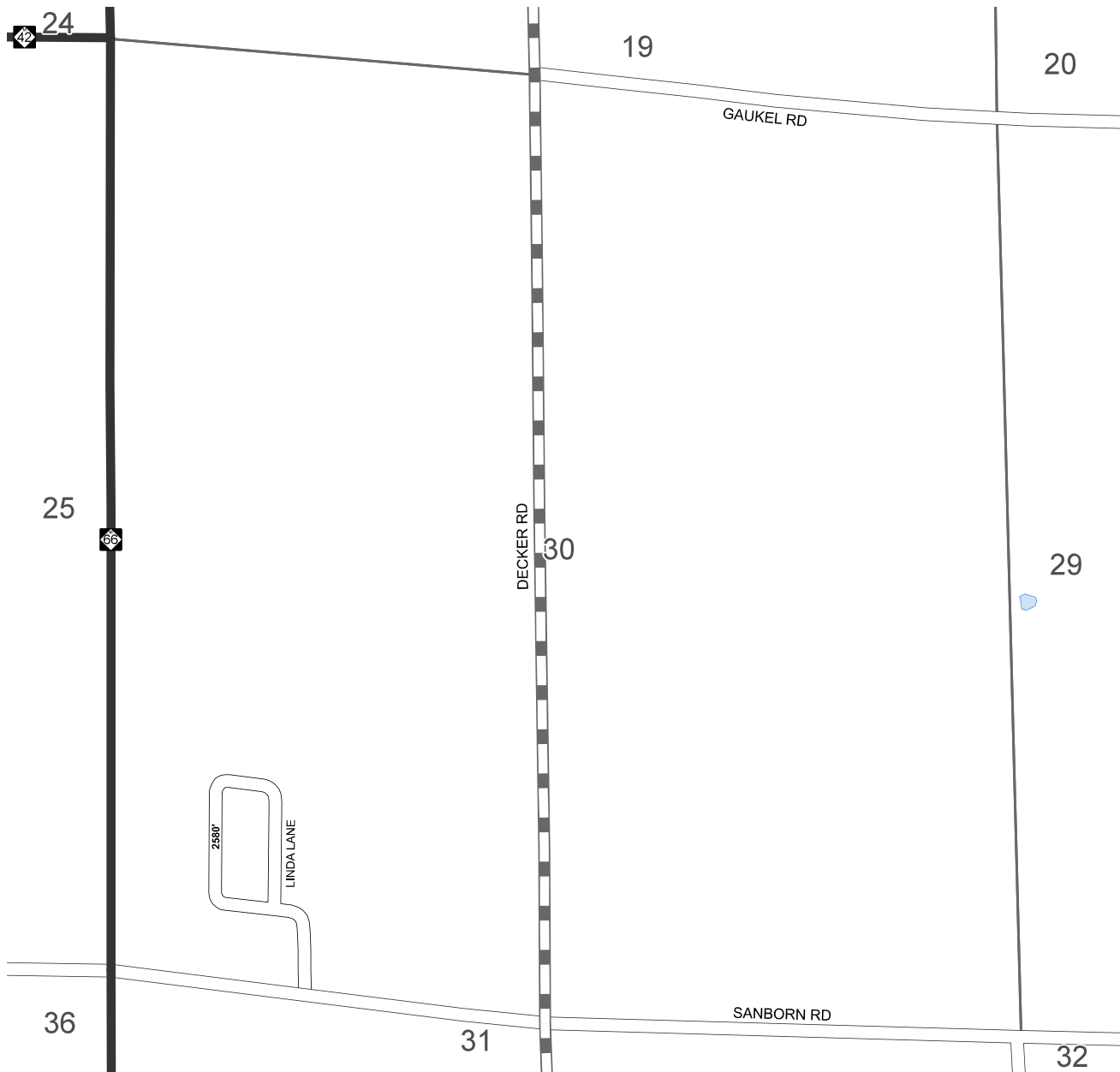

**MISSAUKEE COUNTY ROAD COMMISSION  
LAKE CITY, MICHIGAN**

**LEGEND**

- STATE TRUNKLINE
- COUNTY PRIMARY
- COUNTY LOCAL
- CITY OR VILLAGE STREET
- RAILROAD
- INCORPORATED AREA

TOTAL FEET 2,580 EQUALS 0.49 MILES

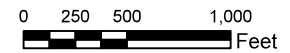
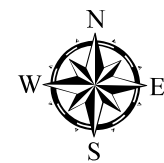

1 inch equals 600 feet

Missaukee Co - 57

T. 23N, R. 07W, S. 30

**FOREST TWP - 10A**

Prepared by  
MISSAUKEE COUNTY ROAD COMMISSION

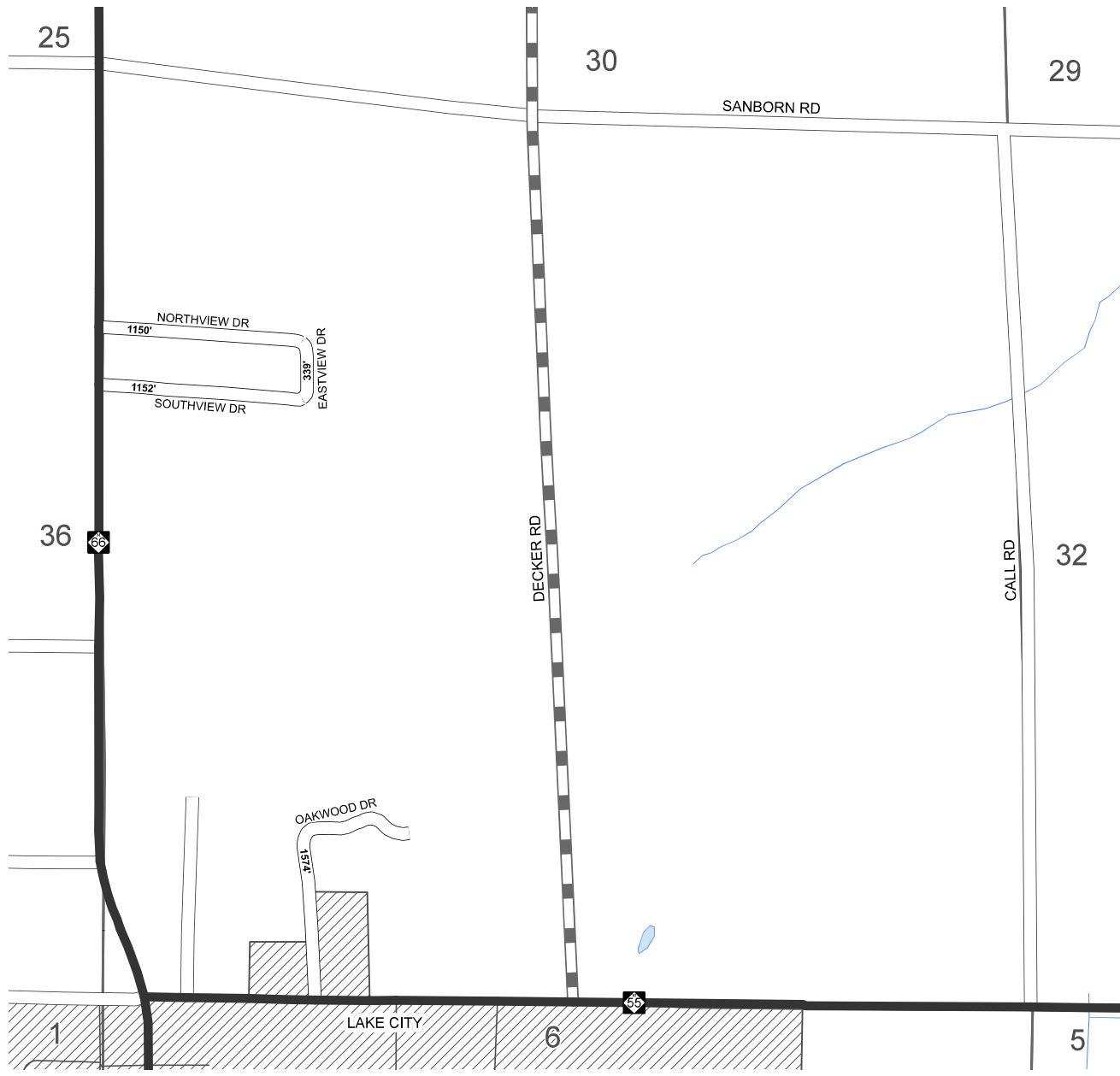

**MISSAUKEE COUNTY ROAD COMMISSION  
LAKE CITY, MICHIGAN**

**LEGEND**

- STATE TRUNKLINE
- COUNTY PRIMARY
- COUNTY LOCAL
- CITY OR VILLAGE STREET
- RAILROAD
- INCORPORATED AREA

TOTAL FEET 4,215 EQUALS 0.80 MILES

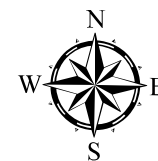

1 inch equals 600 feet

Missaukee Co - 57

T. 23N, R. 07W, S. 31

**FOREST TWP - 10B**

Prepared by  
MISSAUKEE COUNTY ROAD COMMISSION

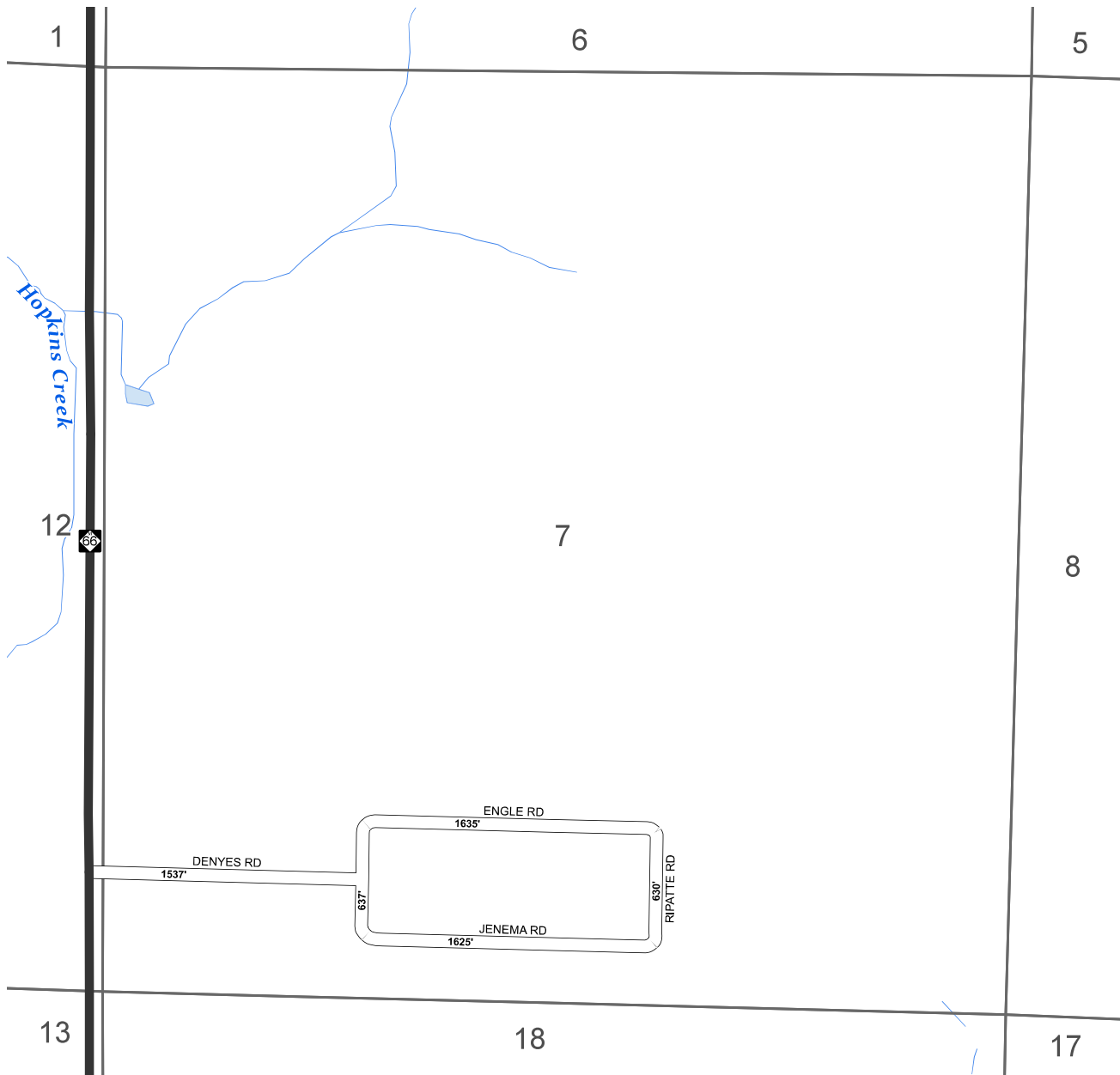

**MISSAUKEE COUNTY ROAD COMMISSION  
LAKE CITY, MICHIGAN**

**LEGEND**

- STATE TRUNKLINE
- COUNTY PRIMARY
- COUNTY LOCAL
- CITY OR VILLAGE STREET
- RAILROAD
- INCORPORATED AREA

TOTAL FEET 6,064 EQUALS 1.15 MILES

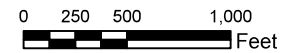
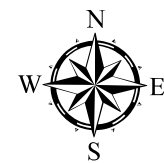

1 inch equals 600 feet

Missaukee Co - 57

T. 23N, R. 07W, S. 7

**FOREST TWP - 10C**

Prepared by  
MISSAUKEE COUNTY ROAD COMMISSION