

COUNTY LINE
 CORPORATE LIMITS
 STATE TOWN LINE
 COUNTY PRIMARY
 COUNTY LOCAL
 ADJACENT COUNTY
 CITY OR VILLAGE
 STREET

PRIMARY ROAD SYSTEM IS 15.14 MILES
 LOCAL ROAD SYSTEM IS 45.08 MILES

I HEREBY CERTIFY THAT THE ROADS SHOWN HEREIN BY SYMBOL OR IN RED AS PRIMARY ROADS AND THOSE SHOWN HEREIN BY SYMBOL OR IN GREEN AS LOCAL ROADS ARE IN USE AND ARE UNDER THE JURISDICTION OF THE COUNTY ROAD COMMISSION.

CHAIRMAN _____ DATE _____



SCALE 0 1/2 1 MILE
 One Inch Equals 3000 Ft.

Prepared by
 RIVERSIDE TWP
 TOWN - R.T.W.
 MISSAUKEE CO.

311415116
9101112
51718
121314

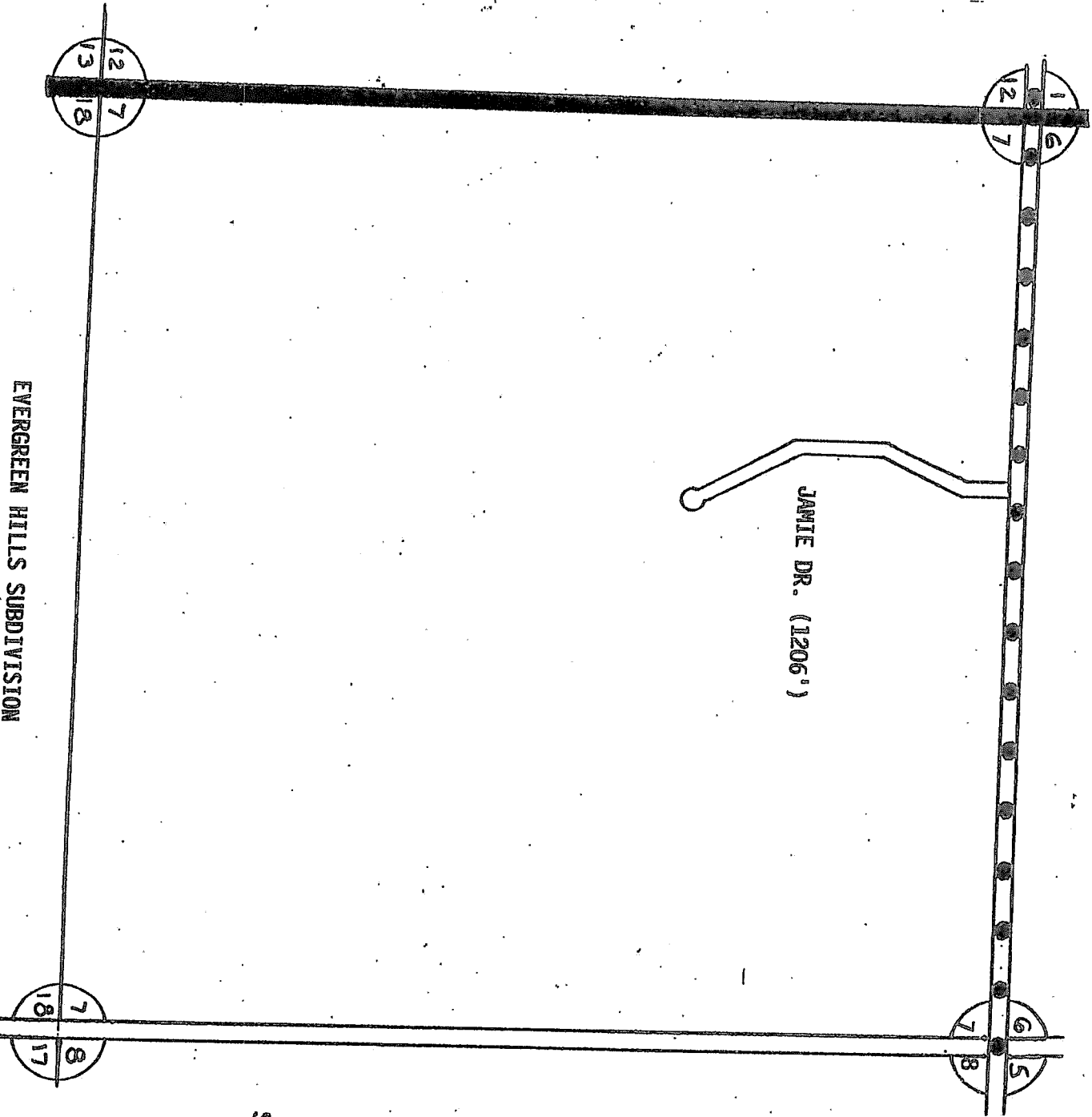

EVERGREEN HILLS SUBDIVISION

LEGEND

- COUNTY LINE
- CORPORATE LIMITS
- STATE TRUNKLINE
- COUNTY PRIMARY
- COUNTY LOCAL
- ADJACENT COUNTY
- CITY OR VILLAGE
- STREET

TOTAL FEET 1206 EQUALS .23 MI.

I HEREBY CERTIFY THAT THE ROADS SHOWN HEREON BY SYMBOL AS LOCAL ROADS ARE IN USE AND ARE UNDER THE JURISDICTION OF THE COUNTY ROAD COMMISSION.

CHAIRMAN _____ DATE _____



SCALE
 0 _____ 1200
 ONE INCH EQUALS 600 FEET

TOWNSHIP RIVERSIDE
 SECTION 7
 COUNTY MISSAUKEE

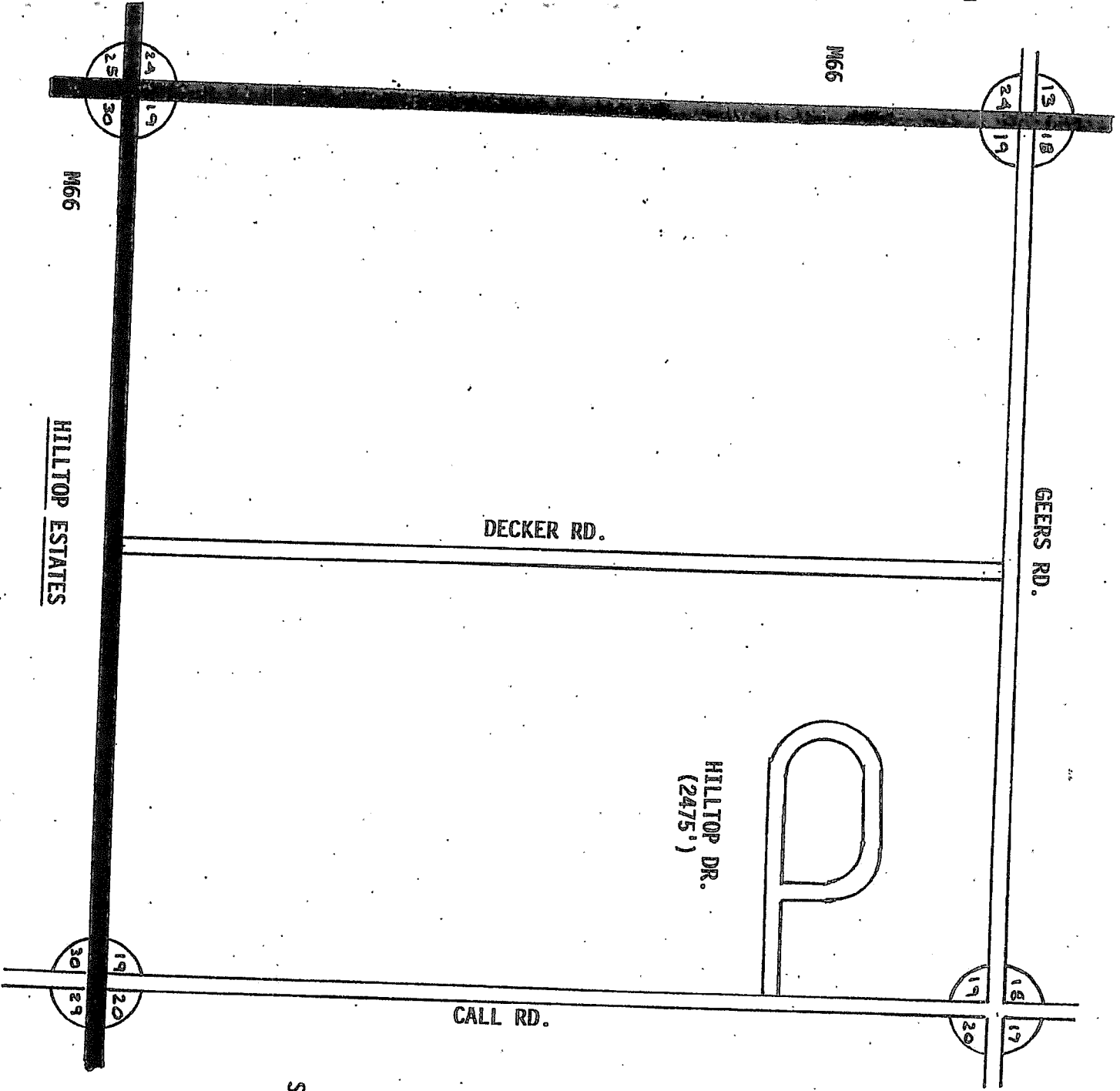

- LEGEND
- COUNTY LINE
 - CORPORATE LIMITS
 - STATE TRUNKLINE
 - COUNTY PRIMARY
 - COUNTY LOCAL
 - ADJACENT COUNTY
 - CITY OR VILLAGE STREET

TOTAL FEET 2475 EQUALS .47 MI.

I HEREBY CERTIFY THAT THE ROADS SHOWN HEREON BY SYMBOL AS LOCAL ROADS ARE IN USE AND ARE UNDER THE JURISDICTION OF THE COUNTY ROAD COMMISSION.

CHAIRMAN _____ DATE _____



SCALE
 0 _____ 1200
 ONE INCH EQUALS ONE MILE

TOWNSHIP RIVERSIDE
 SECTION 19
 COUNTY MISSAUKIE