

COUNTY LINE
 CORPORATE LIMITS
 STATE TRUNK LINE
 COUNTY PRIMARY
 COUNTY LOCAL
 ADJACENT COUNTY
 CITY OR VILLAGE
 STREET

PRIMARY ROAD SYSTEM IS 21.45 MILES
 LOCAL ROAD SYSTEM IS 47.82 MILES

I HEREBY CERTIFY THAT THE ROADS SHOWN HEREON BY SYMBOL OR IN RED AS PRIMARY ROADS AND THOSE SHOWN HEREON BY SYMBOL OR IN GREEN AS LOCAL ROADS ARE IN USE AND ARE UNDER THE JURISDICTION OF THE COUNTY ROAD COMMISSION

CHAIRMAN _____ DATE _____

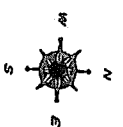

SCALE 0 1/2 1 MILE
 One Inch Equals 3000 Ft

Prepared by
 CLAM UNION TWP.
 T 21 N - R 5 W
 MISSAUKEE CO.

13	14	15	16
9	10	11	12
5	6	7	8
1	2	3	4

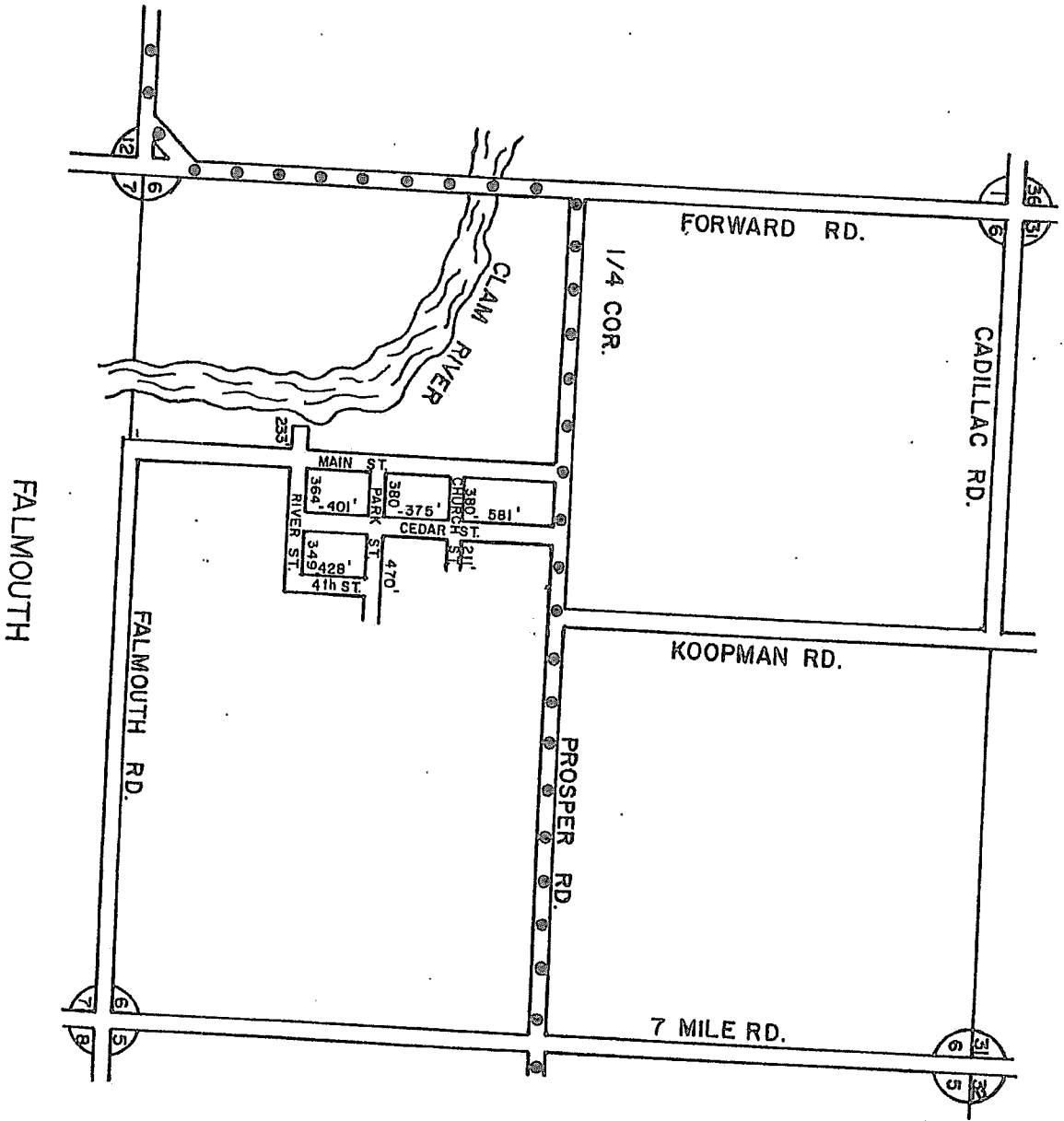

LEGEND

COUNTY LINE _____

CORPORATE LIMITS _____

STATE TOWN/LINE _____

COUNTY PRIMATE _____

COUNTY LOCAL _____

ADJACENT COUNTY _____

CITY OR VILLAGE _____

STREET _____

TOTAL FEET 4172 EQUALS 79 MILES

I HEREBY CERTIFY THAT THE ROADS SHOWN HEREBY BY SYMBOL OR IN GREEN ARE LOCAL ROADS AND ARE UNDER THE JURISDICTION OF THE ROAD COMMISSION.

CHAIRMAN _____ DATE _____

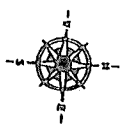

SCALE 6" = 400'

1/2" = 100 FEET

One inch equals 100 feet

TOWNSHIP CLAM UNION

SECTION 6 T. 21N. R. 6W.

COUNTY MISSAUKEE

FALMOUTH

SOUTH DYERS LAKE

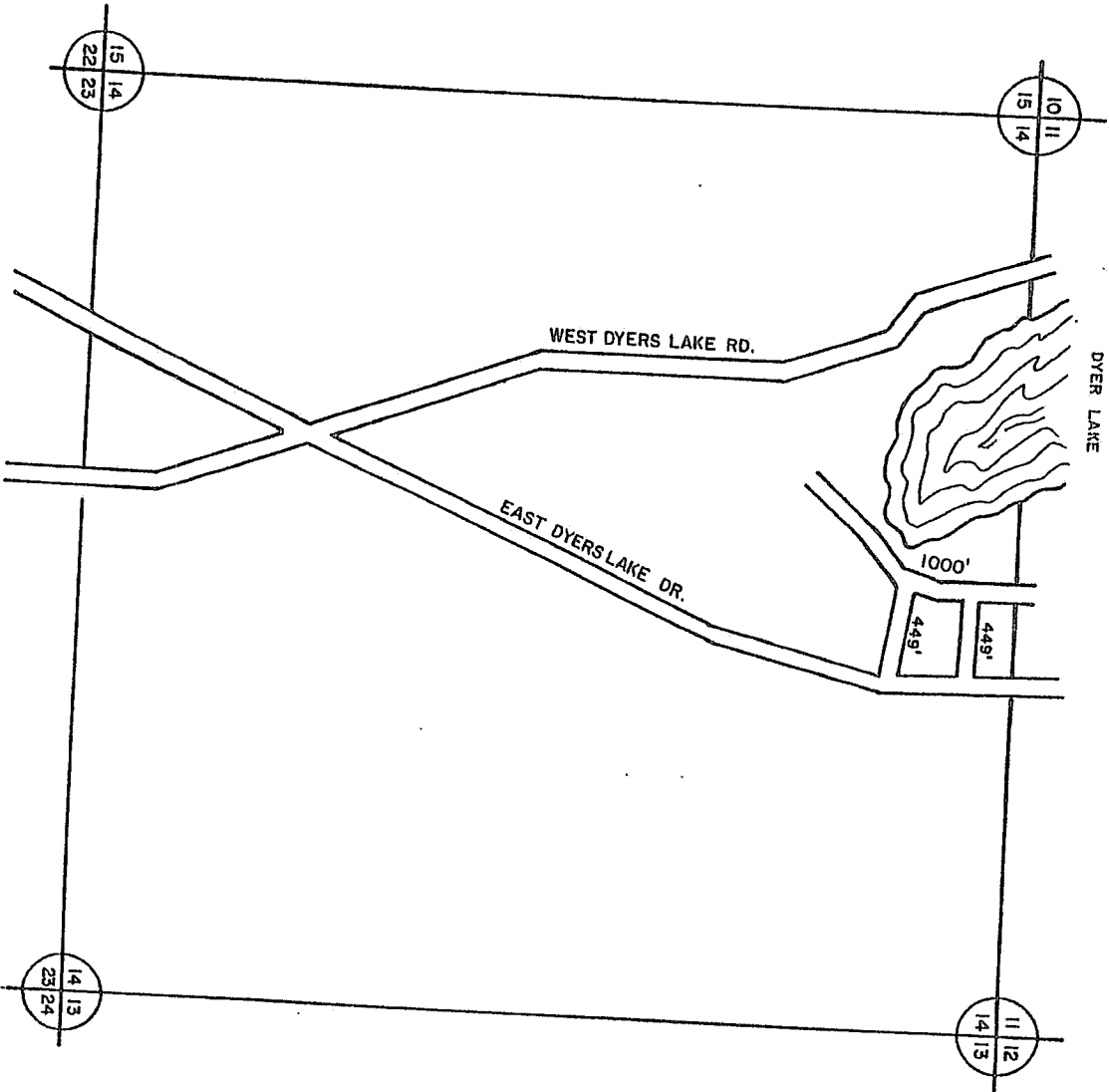

CORPORATE LIMITS
 STATE TRUNKLINE
 COUNTY PRIMARY
 COUNTY LOCAL
 ADJACENT COUNTY
 CITY OR VILLAGE
 STREET

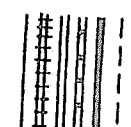

TOTAL FEET 1898 EQUALS .36 M

I HEREBY CERTIFY THAT THE ROADS SHOWN HEREON BY SYMBOL AS LOCAL JURISDICTION OF THE COUNTY ROAD COMMISSION.

CHAIRMAN _____ DATE _____

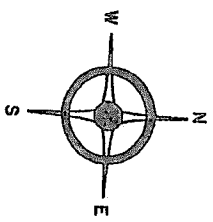

TOWNSHIP CLAM UNION
 SECTION 14 T21N R6W
 COUNTY MISSAUKEE

SCALE
 0 600 1200 FT.
 ONE INCH EQUALS 600 FT.